

CE620

USB DVI HDBase™ 2.0 KVM Extender (Long Reach mode up to 1920 x 1080@150 m)



The ATEN CE620 USB DVI HDBase™ 2.0 KVM Extender integrates the latest HDBase™ 2.0 technologies to provide the most reliable transmission of video, audio, USB and RS-232 signals available on the market. Featured with a Long Reach mode, the CE620 delivers high-quality DVI video, PCM 2-channel digital audio, USB 2.0, and RS-232 signals up to 150 meters using a single Cat6/6a/ATEN [2L-2910](#) Cat 6 cable. With a simple cable installation supporting various signals, the CE620 is ideal for applications where convenient remote access is required – in places such as transportation control centers, medical facilities, industrial warehouses and extended workstations.

Features

- HDBase™ 2.0 connectivity technology
 - Extends video, audio, USB and RS-232 signals via a single Ethernet cable
 - EDID Buffer for smooth power-up and the highest quality display
 - Enhanced bit error detection and correction to resist signal interference during high-quality video transmissions
 - Long distance superior video quality
 - HDBase™ Standard mode up to 1920 x 1200 @ 100 m
 - HDBase™ Long Reach mode up to 1920 x 1080 @ 150 m
 - Long Reach mode switch — switches between HDBase™ Standard and Long Reach modes in a snap
 - 3 USB 2.0 ports for keyboard/mouse and peripherals
 - Supports 2-channel PCM digital audio — ensuring highquality audio transmissions
 - Supports PC Wakeup function via pushbutton or hotkey
 - Built-in 8KV/15KV ESD protection (Contact voltage 8KV; Air voltage 15KV)
- Note: The CE620 does not support HDCP.

Specifications

| Function | CE620L | CE620R |
|---------------|----------------------------------------------------------------------------------------------------------------------------------------|--------------------------------------------------------------------------------------------------------------------------------|
| Connectors | | |
| KVM Ports | 1 x DVI-D Female (White) 1 x USB Type B Female (White) 1 x Mini Stereo Jack Female (Green) 1 x Mini Stereo Jack Female (Pink) | N/A |
| Console Ports | N/A | 1 x DVI-D Female (White) 3 x USB Type A Female 1 x Mini Stereo Jack Female (Green) 1 x Mini Stereo Jack Female (Pink) |
| RS-232 | 1 x DB-9 Female (Black) | 1 x DB-9 Male (Black) |

| | | |
|------------------------|----------------------------------------------------------------------------------------------------------------------------------------------------------------------------------------------------------------------------------------------------|----------------------------------------------------------------------------------------------------------------------------------------------------------------------------------------------------------------------------------------------------|
| Power | 1 x DC Jack with locking | 1 x DC Jack with locking |
| Unit To Unit | 1 x RJ-45 Female (Black) | 1 x RJ-45 Female (Black) |
| LEDs | | |
| Power | 1 (Green) | 1 (Green) |
| Link | 1 (Orange) | 1 (Orange) |
| Video Output | N/A | 1 (Orange) |
| Switches | | |
| Long Reach Mode Switch | 1 x Slide Switch | 1 x Slide Switch |
| Firmware Upgrade | 1 x Slide Switch | 1 x Slide Switch |
| Pushbuttons | | |
| Wakeup button | N/A | 1 x Push button |
| Video | Up to 1600x1200 & 1920x1200@90m (Cat 5e) / 100m (cat 6/6a) 1920x1080@150m (Long reach mode enable) | Up to 1600x1200 & 1920x1200@90m (Cat 5e) / 100m (cat 6/6a) 1920x1080@150m (Long reach mode enable) |
| Power Consumption | DC5V:2.68W:13BTU/h Note: ● The measurement in Watts indicates the typical power consumption of the device with no external loading. ● The measurement in BTU/h indicates the power consumption of the device when it is fully loaded. | DC5V:5.02W:28BTU/h Note: ● The measurement in Watts indicates the typical power consumption of the device with no external loading. ● The measurement in BTU/h indicates the power consumption of the device when it is fully loaded. |
| Environmental | | |
| Operating Temperature | 0–40°C | 0–40°C |
| Storage Temperature | -20–60°C | -20–60°C |
| Humidity | 0–80% RH, Non-condensing | 0–80% RH, Non-condensing |
| Physical Properties | | |
| Housing | Metal | Metal |
| Weight | 0.63 kg (1.39 lb) | 0.64 kg (1.41 lb) |
| Dimensions (L x W x H) | 18.20 x 12.28 x 2.87 cm (7.17 x 4.83 x 1.13 in.) | 18.20 x 12.28 x 2.87 cm (7.17 x 4.83 x 1.13 in.) |
| Note | For some of rack mount products, please note that the standard physical dimensions of WxDxH are expressed using a LxWxH format. | |

Diagram

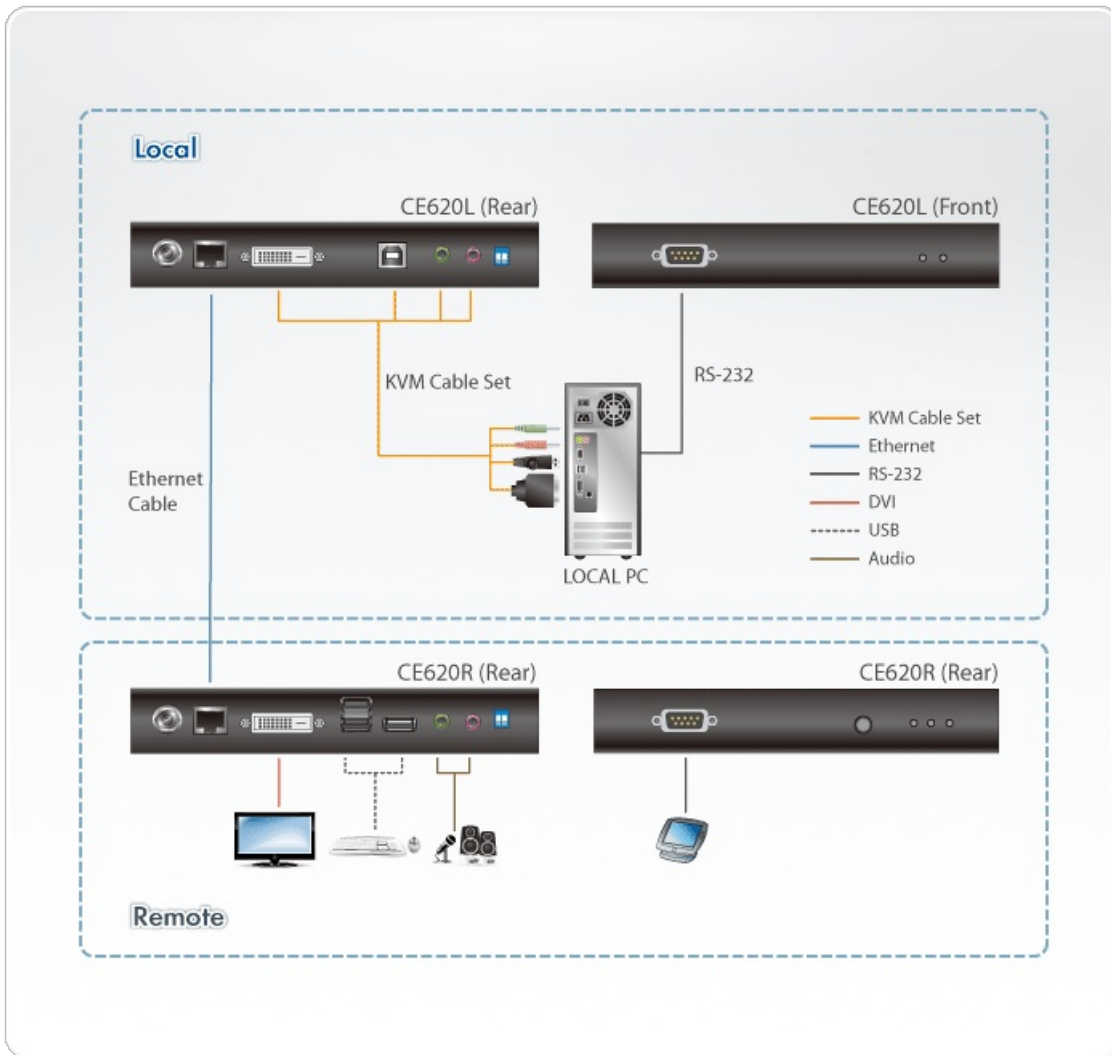

ATEN International Co., Ltd.

3F., No.125, Sec. 2, Datong Rd., Sijhih District., New Taipei City 221, Taiwan
 Phone: 886-2-8692-6789 Fax: 886-2-8692-6767
 www.aten.com E-mail: marketing@aten.com



© Copyright 2015 ATEN® International Co., Ltd.
 ATEN and the ATEN logo are trademarks of ATEN International Co., Ltd.
 All rights reserved. All other trademarks are the property of their
 respective owners.