

VS481B

4-Port 4K HDMI Switch



Instant 4K Switching Across 4 HDMI Sources



Nintendo Switch and related logos are registered trademarks of Nintendo of America, Inc. References to services and compatible products, such as those offered and produced by Nintendo are not intended to suggest any endorsement or sponsorship by or affiliation with product manufacturers.

VS481B
4-Port 4K HDMI Switch

The VS481B is a 4-port video switch that enables fast switching between four HDMI sources, delivering up to 4K audiovisual content to a single HDMI display. It's an ideal addition to any AV setup where multiple video feeds need to be shared and switched instantly – perfect for home entertainment systems, meeting rooms, retail displays, and more.

Instant Switching between 4 HDMI Inputs

Enjoy a variety of video content by switching between 4 HDMI source devices, such as computers, media players, and more.



VS481B Video Switch

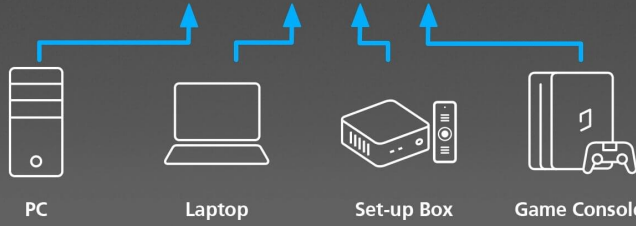

PC

Laptop

Set-up Box

Game Console

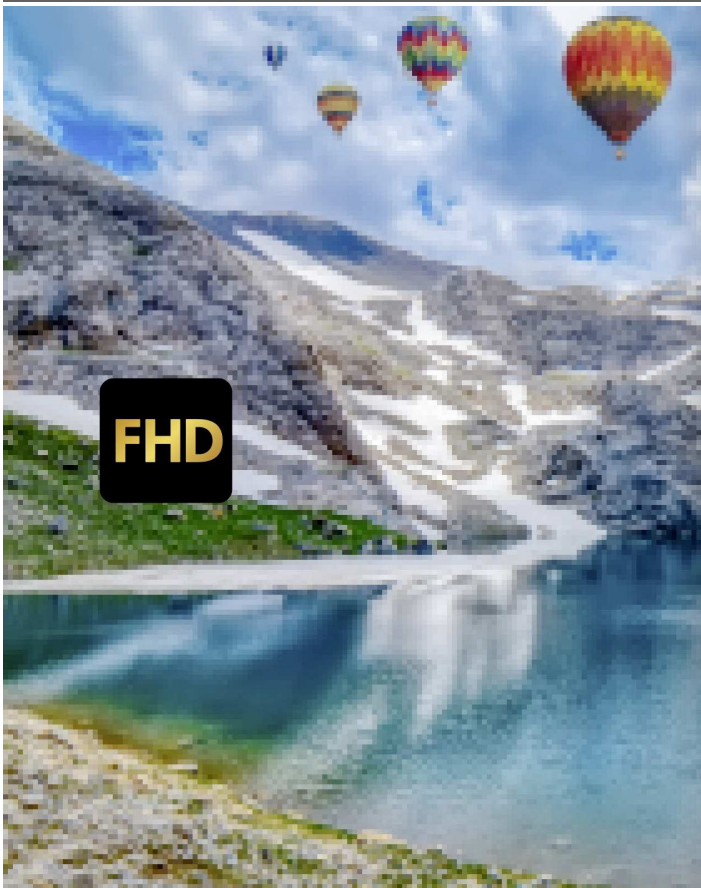

FHD

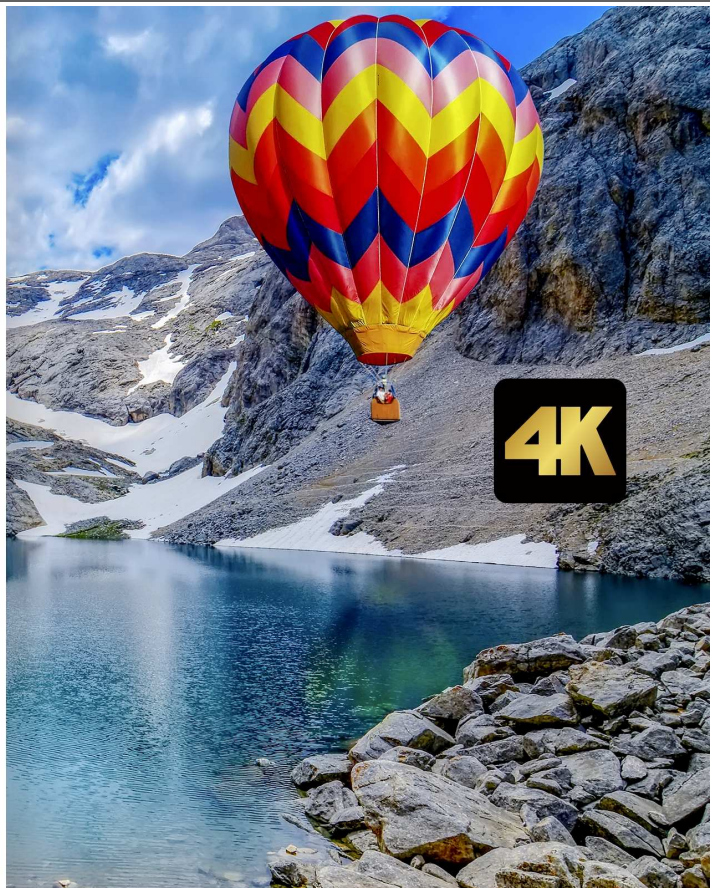

4K

Pristine 4K Clarity

The VS481B supports Ultra HD resolutions up to 4K (3840x2160 @ 30Hz, 4:4:4), delivering crystal-clear detail.

Long-Distance 4K Transmission

The video switch supports flexible cabling, with connections to each HDMI source up to 3 meters ([2L-7D03H](#) recommended) and to the HDMI display up to 15 meters ([2L-7D15H](#) recommended), delivering optimal 4K visual clarity (4096 x 2160 / 3840 x 2160 @ 30Hz, 4:4:4) in any AV setup.



Flexible Switching Options

Switching is made easy with front-panel pushbuttons or the included IR remote control. Port selection can also be managed via a high-end controller, PC, or automation/theater software through an RS-232 serial connection to the switch. Or simply enable Auto Switch mode to automatically prioritize the most recently connected device as the video source.



▶ Pushbutton



Remote Control ▶



▶ RS-232 Control



Auto Switch ▶

Applications

The VS481B is well suited for any commercial or professional application requiring instant switching between multiple video sources for various viewing purposes.

- 1.
- 2.
- 3.
- 4.





Classroom



Meeting Room



Post Production

[Previous](#) [Next](#)

Commitment to Best Quality

Each product is rigorously tested under diverse environmental conditions to ensure high-quality, reliable, and cost-effective performance for our customers.

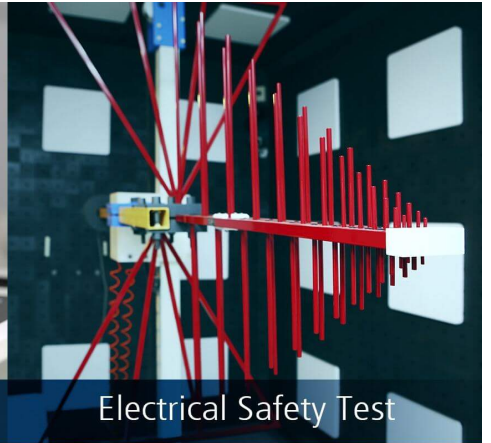

Talk to Our Experts

If you prefer to have ATEN contact you, please complete the form and a representative will be in touch with you shortly

First Name *

Last Name *

- Country *

Company *

Email *

Phone Number *

- Customer Type *

Job Title *



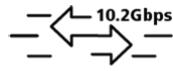

10.2Gbps Max.
Bandwidth

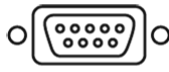

RS-232 Control



Flexible
Switching



IR Remote
Control

Features

The VS481B 4-Port HDMI Switch allows you to quickly connect 4 HDMI sources to your HDMI display and easily switch between them via front panel pushbuttons, RS-232 or IR remote control. The front panel's LEDs indicate the source device selected for the display at a glance.

The VS481B supports Ultra HD 4Kx2K, the newest resolution for high definition displays; Auto Switching modes for auto port selection; Instant Switching for a smooth video transition between HDMI ports with increased efficiency; and features a built-in bi-directional RS-232 serial port that allows the switch to be controlled through a high-end controller, PC, and/or home automation/home theater software package.

- Allows up to four HDMI A/V sources to be connected to one HDMI display
- Quick and easy switching between HDMI sources via front panel pushbuttons, RS-232 or IR Remote control
- Supports 340MHz bandwidth for ultrahigh 4kx2k video
- HDMI (3D, Deep Color, 4kx2k); HDCP compatible
- Auto switching modes for auto port selection
- Long distance transmission – up to 15 m (24 AWG)
- Consumer Electronics Control (CEC) support
- Supports Dolby True HD and DTS HD Master Audio
- Built-in bi-directional RS-232 serial remote port for high-end system control
- Instant switching between HDMI input sources
- Supports IR extension using a IR extension cable *
- LED indication of video source devices

Note: The IR extension cable (Part No. [2XRT-0003G](#)) is not included in this package.

Specifications

Video Input	
Interfaces	4 x HDMI Type A Female (Black)
Impedance	100 Ω
Max. Distance	3m @3840x2160@30 (4:4:4)
Video Output	
Interfaces	1 x HDMI Type A Female (Black)
Impedance	100 Ω
Max. Distance	15m @3840x2160@30 (4:4:4)
Video	
Max. Data Rate	10.2 Gbps (3.4 Gbps per lane)
Max. Pixel Clock	340 MHz
Compliance	HDMI (3D, Deep Color, 4K) HDCP Compatible Consumer Electronics Control (CEC)
Max. Resolution	Up to 4096 x 2160 / 3840 x 2160 @ 60Hz (4:2:0); 4096 x 2160 / 3840 x 2160 @ 30Hz (4:4:4)
Control	
RS-232	Connector: 1 x DB-9 Female (Black) Baud Rate and Protocol: Baud Rate: 19200, Data Bits: 8, Stop Bits: 1, Parity: No, Flow Control: No
IR	1 x Mini Stereo Jack Female (Black)
Connectors	
Power	Connector: 1 x DC Jack
Power Consumption	DC5V:1.76W:8BTU/h Note: ● The measurement in Watts indicates the typical power consumption of the device with no external loading. ● The measurement in BTU/h indicates the power consumption of the device when it is fully loaded.
Environmental	
Operating Temperature	0 - 50°C
Storage Temperature	-20 - 60°C
Humidity	0 - 80% RH, Non-Condensing
Physical Properties	
Housing	Metal
Weight	0.48 kg (1.06 lb)
Dimensions (L x W x H)	20.00 x 8.25 x 2.50 cm (7.87 x 3.25 x 0.98 in.)
Carton Lot	10 pcs
Note	For some of rack mount products, please note that the standard physical dimensions of WxDxH are expressed using a LxWxH format.

Diagram

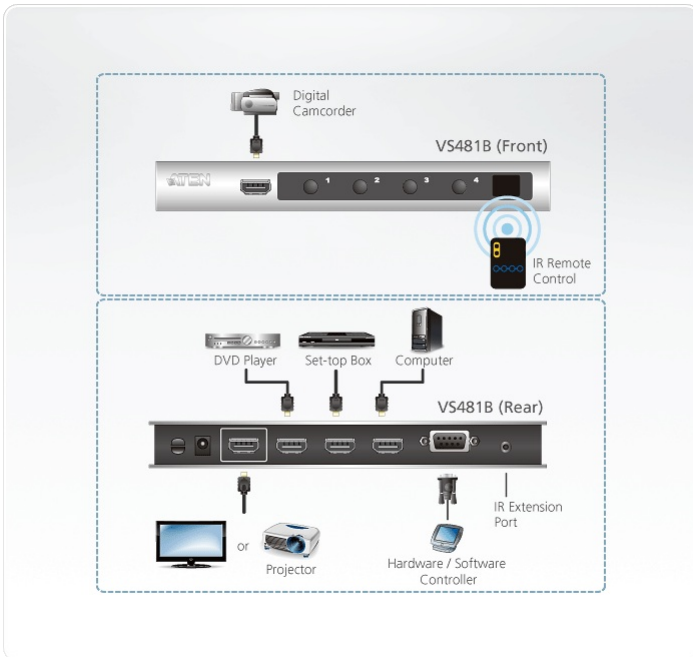

ATEN International Co., Ltd.

3F., No. 125, Sec. 2, Datong Rd., Sijhih District., New Taipei City 221, Taiwan
Phone: 886-2-8692-6789 Fax: 886-2-8692-6767
www.aten.com E-mail: marketing@aten.com



© Copyright 2015 ATEN® International Co., Ltd.
ATEN and the ATEN logo are trademarks of ATEN International Co., Ltd.
All rights reserved. All other trademarks are the property of their respective owners.