

## CE700A

USB VGA Cat 5 KVM Extender (1280 x 1024@150m)



The CE700A is a USB [KVM Extender](#) with superior video quality and built-in ESD and surge protection that allows access to a computer system up to 150 meters away from a remote USB console (USB keyboard, monitor, and USB mouse).

The CE700A improves on previous designs by: 1) incorporating 8KV/15KV ESD protection and 2KV surge protection; 2) providing superior video quality - up to 1920 x 1200 resolution; 3) using inexpensive Cat 5e cable, instead of bulkier, more expensive, standard cables, for a much neater, more convenient, more reliable data transfer connection; 4) it is able to sense the distance to the system and automatically adjusts the gain accordingly; and 5) it features a custom ASIC to ensure the utmost in reliability and compatibility.

### Features

- Cat 5e cable connects the Local and Remote Units - up to 150m apart
- Dual console operation - control your system from both the local and remote USB keyboard, monitor, and mouse consoles
- Built-in ASIC for greater reliability and compatibility
- Auto Signal Compensation (ASC)
- USB Keyboard and USB Mouse Ports
- USB overcurrent detection and prevention
- Pushbutton operating mode selection (Local Unit only) - select between Local and Auto operating modes.
- Built-in 8KV/15KV ESD protection (Contact voltage 8KV; Air voltage 15KV) and 2KV surge protection
- Automatic gain control - adjusts signal strength to compensate for distance
- High resolution video - up to 1920 x 1200@60Hz (30m ); 1600 x 1200@60Hz (100m); 1280 x 1024@60Hz (150m)
- Supports Wide Screen formats \*
- Supports VGA, SVGA, SXGA, UXGA, WUXGA and multisyncmonitors; local monitor supports DDC; DDC2; DDC2B
- Rack mountable Easy to install - no software required - connecting cables to the devices is all it takes
- Multiplatform support - Windows, Linux

\* The EDID data for a widescreen is sent from the local video output port. For widescreen modes and displays connect the monitor to the local video output port or use an ATEN EDID emulator.

### Specifications

| Function      | CE700AL   | CE700AR   |
|---------------|---|---|
| Connectors    |   |   |
| Console Ports | 2 x USB Type A Female (White)<br>1 x HDB-15 Female (Blue) | 2 x USB Type A Female (White)<br>1 x HDB-15 Female (Blue) |
| KVM Ports     | 1 x SPHD-17 Female (Green)                                | N/A   |
| Unit To Unit  | 1 x RJ-45 Female (Black)                                  | 1 x RJ-45 Female (Black)                                  |

|                          |  |  |
|--------------------------|--|--|
| Power                    | 1 x DC Jack (Black)  | 1 x DC Jack (Black)  |
| Pushbuttons              |  |  |
| Operating Mode Selection | 1 x Pushbutton   | N/A  |
| LEDs                     |  |  |
| Local                    | 1 (Green)  | N/A  |
| Remote                   | 1 (Green)  | 1 (Green)  |
| Link                     | N/A  | 1 (Green)  |
| Emulation                |  |  |
| Keyboard / Mouse         | USB  | USB  |
| Power Consumption        | DC5.3V:2.17W:14BTU/h<br><br>Note:<br>● The measurement in Watts indicates the typical power consumption of the device with no external loading.<br>● The measurement in BTU/h indicates the power consumption of the device when it is fully loaded. | DC5.3V:1.59W:12BTU/h<br><br>Note:<br>● The measurement in Watts indicates the typical power consumption of the device with no external loading.<br>● The measurement in BTU/h indicates the power consumption of the device when it is fully loaded. |
| Video                    | 1920 x 1200 @ 60Hz (30m)<br>1600 x 1200 @ 60Hz (100m)<br>1280 x 1024 @ 60Hz (150m)   | 1920 x 1200 @ 60Hz (30m)<br>1600 x 1200 @ 60Hz (100m)<br>1280 x 1024 @ 60Hz (150m)   |
| Environmental            |  |  |
| Operating Temperature    | 0 - 50°C   | 0 - 50°C   |
| Storage Temperature      | -20 - 60°C   | -20 - 60°C   |
| Humidity                 | 0-80% RH, Non-condensing   | 0-80% RH, Non-condensing   |
| Physical Properties      |  |  |
| Housing                  | Metal  | Metal  |
| Weight                   | 0.33 kg ( 0.73 lb )  | 0.32 kg ( 0.7 lb )   |
| Dimensions (L x W x H)   | 12.70 x 8.65 x 2.50 cm<br>(5 x 3.41 x 0.98 in.)  | 12.70 x 8.14 x 2.50 cm<br>(5 x 3.2 x 0.98 in.)   |
| Note                     | For some of rack mount products, please note that the standard physical dimensions of WxDxH are expressed using a LxWxH format.  |  |

Diagram

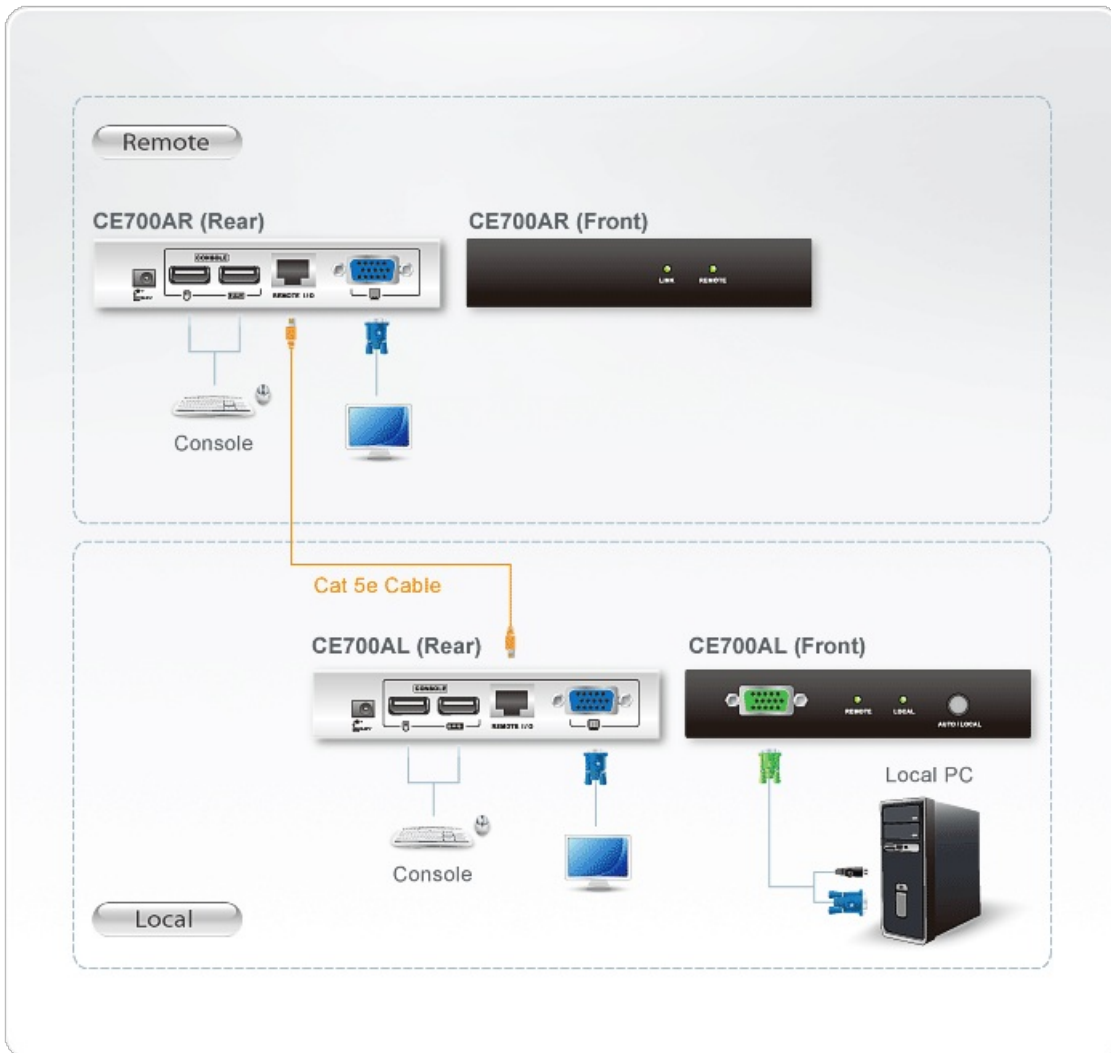

**ATEN International Co., Ltd.**

3F., No.125, Sec. 2, Datong Rd., Sijhih District., New Taipei City 221, Taiwan  
 Phone: 886-2-8692-6789 Fax: 886-2-8692-6767  
 www.aten.com E-mail: marketing@aten.com



© Copyright 2015 ATEN® International Co., Ltd.  
 ATEN and the ATEN logo are trademarks of ATEN International Co., Ltd.  
 All rights reserved. All other trademarks are the property of their respective owners.